

EXHIBITOR and Contractor Information

During the exhibition period, exhibitors will have access to the exhibition thirty minutes before the opening hours and thirty minutes after the closing hours to service their stands or exhibits.(excluding breakdown day) Exhibitors, who require access beyond these given hours, please contact the Organizer in advance.

BUILD-UP		
<p style="text-align: center;"><u>Sunday</u> 1 November 2009</p>	08:00 – 00:00 hrs.	Official Contractor move-in <i>Deposit cheque shall be handed before move-in</i>
	12:00 – 14:00 hrs.	Other Contractors receive passes at loading Hall 103
	08:00 – 00:00 hrs.	Loading Queue 8.00 - 12.00 - Official Contractor move-in - Sponsor Contractor Loading 12.00 - 0.00 - Other Contractors move-in
<p style="text-align: center;"><u>Monday</u> 2 November 2009</p>	08:00 – 15:00 hrs.	Other Contractors move-in Exhibitors move-in for Decoration
	08.30- 19.00 hrs.	<i>Exhibitor Registration at Registration counter in front of Hall EH 103</i>
	** All gangway to be cleared by 12:00 hrs. **	
	13:00 – 15:00 hrs.	Gangway carpet laying
	** All work to be completed by 15:00 hrs. ** due to preparation for welcome reception	
	18:00 – 18:30 hrs.	Welcome Reception at exhibition area in front of Hall 103
18:30 – 20:00 hrs.	Exhibition opens for all delegates	
Any working in the hall outside of these hours will be subject to an overtime charge directly by Customer Services Department, BITEC in cash only at Business Center which depends on the number of hours and the size of stand.		

OPEN DAYS		
<p style="text-align: center;"><u>Tuesday</u> 3 November 2009</p>	07:30 – 08:30 hrs.	Exhibition open to Exhibitors only
	09:30 – 10:30 hrs. <i>(Opening Ceremony time is subjected to be changed)</i>	Opening Ceremony presided over by H.R.H. Princess Chulabhorn at room GH 203 <i>Please be seated in GH 203 before 9.00am to attend the opening ceremony.</i>
	** All work to be complete and no activities in exhibition are allowed before 09:30 hrs. **	
	10:30 – 18:30 hrs.	Exhibition opens
	19:00 hrs.	Exhibition hall close
<p style="text-align: center;"><u>Wednesday</u> 4 November 2009</p>	07:30 – 08:00 hrs.	Exhibition open to Exhibitors only
	08:00 – 18:30 hrs.	Exhibition opens
	19:00 hrs.	Exhibition hall close
<p style="text-align: center;"><u>Thursday</u> 5 November 2009</p>	07:30 – 08:00 hrs.	Exhibition open to Exhibitors only
	08:00 – 18:00 hrs.	Exhibition opens
	17:40 – 18:00 hrs.	Closing Ceremony
	** No removal of exhibits is permitted before 18:15 hrs. **	

BREAKDOWN		
<p style="text-align: center;"><u>Thursday</u> 5 November 2009</p>	18:15 – 19:15 hrs.	Exhibitors to remove contents of stand <i>Deposit cheque shall be returned at Organizer office / front of EH 103 on Nov 12 at 19.00 hrs.</i>
	19:15 – 00:00 hrs.	Breakdown (Arena to be cleared by 00:00 – end of FASAVA tenancy)
<ul style="list-style-type: none"> No removal of exhibits is permitted before the closure of the exhibition at 18:15 hrs. This will be strictly enforced. All equipment and materials must be removed from the exhibition areas by 00:00 hrs. Any items left in the hall after this time will be disposed of and the costs incurred will be charged to the exhibitor. Any working in the hall outside of these hours will be subject to an overtime charge directly by Customer Services Department, BITEC in cash only at Business Center which depends on the number of hours and the size of stand. 		

Please read:

* It is your responsibility as an exhibitor to secure the items on your stand. FASAVA Organizer arranges the necessary security for general hall cover only.

Any loss or damage in your stand will not be responsibility of Fasava Organizer.

* Delivery of machinery requiring the assistance of the sole lifting contractor must be pre-arranged through Elite Transportation Services Ltd.

BITEC

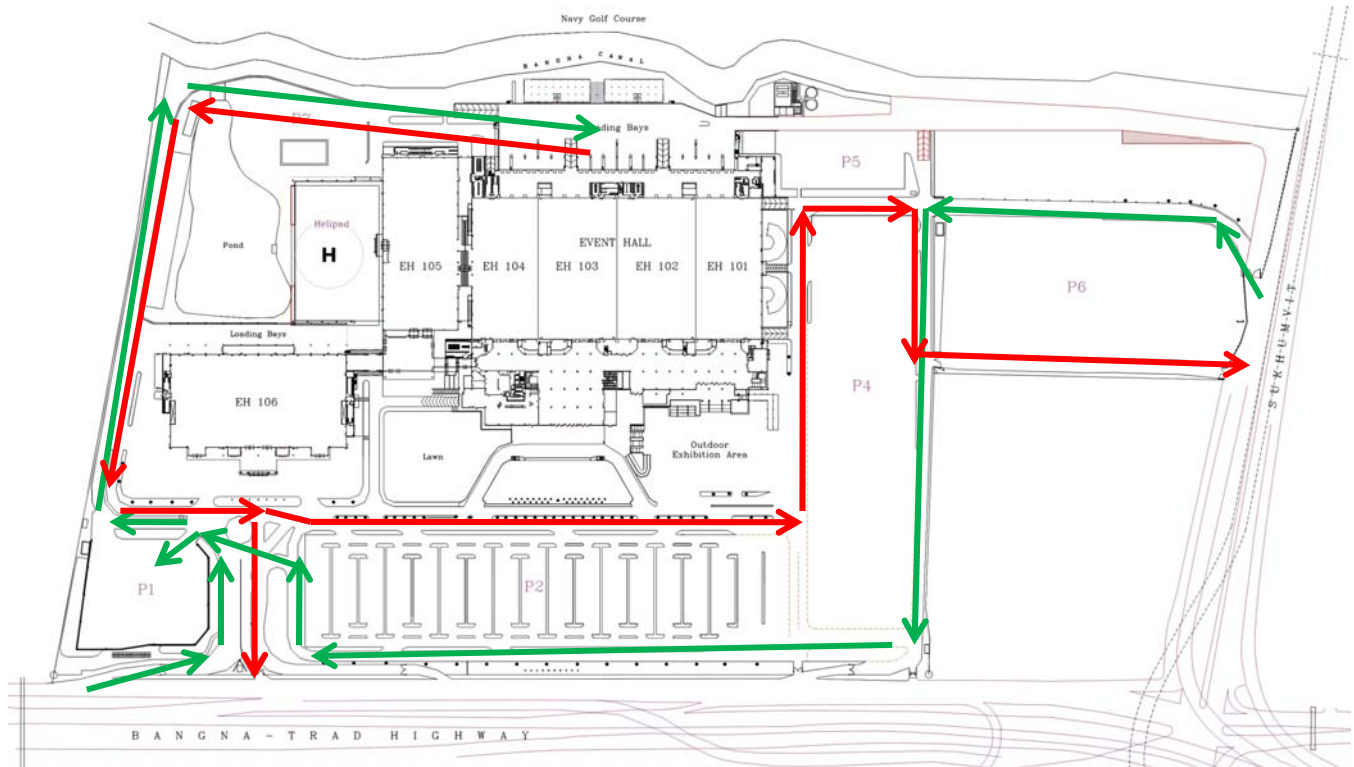

Loading path



Regulation of Greeting HRH Princess Chulabhorn at Opening Ceremony on November 3rd, 2009

- The opening Ceremony will be held on November 3rd, 2009 from 9.00 to 10.00 hrs. at GH 203 on the 2nd Fl. of BITEC
- Exhibition Opening will be at 10.00 am at Hall EH 103
- Participants without badges will not allow to enter GH 203 (opening room) and EH 103 (exhibition hall).
- Please enroll your badges on November 2 at registration desk in front of Hall EH 103 from 08.00 am – 19.00 hrs.
- Present for the princess shall be handed at “Present desk” on November 2nd, 2009 at 06.30-07.00 hrs. for security check. Each present shall be labeled with name, address and telephone number of a provider. NO present is allowed to be handed to the princess.
- For the participant of the opening ceremony, please wear formal dress and no slippers. Dressing in black and short-sleeve is not appropriated.
- For safety of greeting rules, you are not allowed to take photo, record any picture or audio during the ceremony.
- All participants shall be seated in the fixed place in the room# GH203 within 09.00 am.
- After the chairperson of the opening ceremony departed, the Committee will provide the registration. Those who did not enroll can complete the enrollment from 10.30 – 19.00hrs.

EXHIBITORS LIST

By Company Name		By Booth Number	
Company	Booth No.	Company	Booth No.
Abaxis	A6	iM3 - The VETERINARY DENTAL CO.	A1
ADVANCED VETRACEUTICAL Co., LTD	A13	Vinci Technology Co.,Ltd.	A2
ANS INTERNATIONAL CUSTOM TAILORS	H3	Cute Pet Supply Co., Ltd.	A4
ASAVA	T1	EcoRay Co., Ltd	A5
Austam Goods Corp., Ltd.	E7	Abaxis	A6
Bayer Animal Health GmbH	B4	KARL STORZ GMBH @ CO.KG	A7
BEIJING READ EAGLE TECHNOLOGY CO.,LTD	B7/2	GENIA S.A.	A8
Betagro group	F1	GISS MARKETING CO.,LTD	A9
Best Equipment Center Co., Ltd.	G3	ELSEVIER	A10
BIC CHEMICAL CO., LTD	F10	TETRAGON CHEME (PVT.) LTD	A11
BN SUPERIOR MARKETING CO., LTD	A16-A17	Touchwood Forestry Co., Ltd.	A12
Cute Pet Supply Co., Ltd.	A4	ADVANCED VETRACEUTICAL Co., LTD	A13
Charoen Pokphand Foods Public Company Limited	B1	DESTRON FEARING	A14
		PAKORNPAN MEDICAL SUPPLY	A15
Chulalongkorn University Veterinary Alumni Association	T13	BN SUPERIOR MARKETING CO., LTD	A16-A17
Dr.Hippo	G17	Veterina (Thailand) Co.,Ltd	A19
EcoRay Co., Ltd	A5	Charoen Pokphand Foods Public Company Limited	B1
Eickemeyer Veterinary Equipment	G1-G2	Merial (Thailand) Limited	B3
ELSEVIER	A10	Bayer Animal Health GmbH	B4
EN-TO-EN INTERTRADE CO.,LTD.	H1	Idexx	B5
ESAVS	T6	VETPLUS INTERNATIONAL LIMITED	B6
ESAOTE ULTRASOUND & MRI	E9	Veterinary Practitioner NEWS (VPN)	B7/1
Fac.Vet Sc	T12	BEIJING READ EAGLE TECHNOLOGY CO.,LTD	B7/2
Faculty of Veterinary Technology, KU.	T10	Fort Dodge	B8
FAVA & ASVP	T8	MILLLEDGE VETERINARY	B10
Fort Dodge	B8	VRVC	B12
GENIA S.A.	A8	PROVET Pty Ltd	C7
GISS MARKETING CO.,LTD	A9	Vetquip.com.au	C9
Hill's	D1	WILEY-BLACKWELL	C10
iM3 - The VETERINARY DENTAL CO.	A1	O-Square Distribution	C12
Idexx	B5	Hill's	D1
Intervet/Schering-Plough	F3	Austam Goods Corp., Ltd.	E7
Interdisciplinary Graduate Program in Genetic Engineering	T11	ESAOTE ULTRASOUND & MRI	E9
J Summit	H2	Veterinary Instrumentation Ltd	E10
JORGEN KRUSSE A/S	G4	Soar Medical-Tech Co., Ltd	E12
JORGENSEN LABORATORIES	F12	Betagro group	F1
KARL STORZ GMBH @ CO.KG	A7	PFIZER THAILAND LIMITED	F2
KODO Incorporated	F5	Intervet/Schering-Plough	F3
Merial (Thailand) Limited	B3	Virbac	F4
MERGE COMPANION (THAILAND) Co., Ltd	G15-G16	KODO Incorporated	F5
Murdoch University	T3	Protexin Veterinary	F6
MILLLEDGE VETERINARY	B10	Royal Canin/Best pet Food	F8
O-Square Distribution Co.,Ltd	C12	BIC CHEMICAL CO., LTD	F10
PAKORNPAN MEDICAL SUPPLY	A15	JORGENSEN LABORATORIES	F12
PetAg, Inc.	G14	Eickemeyer Veterinary Equipment	G1-G2
Pet World Centre Co., Ltd.	H4	Best Equipment Center Co., Ltd.	G3
PFIZER THAILAND LIMITED	F2	JORGEN KRUSSE A/S	G4
Protexin Veterinary	F6	UNOVET GROUP	G12
PROVET Pty Ltd	C7	VetMedCare	G13
DESTRON FEARING	A14	PetAg, Inc.	G14
Royal Canin/Best pet Food	F8	MERGE COMPANION (THAILAND) Co., Ltd	G15-G16
SCHOOL OF VETERINARY MEDICINE, UNIVERSITY OF CALIFORNIA-DAVIS	T2	Dr.Hippo	G17
Soar Medical-Tech Co., Ltd	E12	EN-TO-EN INTERTRADE CO.,LTD.	H1
TETRAGON CHEME (PVT.) LTD	A11	J Summit	H2
Touchwood Forestry Co., Ltd.	A12	ANS INTERNATIONAL CUSTOM TAILORS	H3
TVMA	T7	Pet World Centre Co., Ltd.	H4
U.F.O. Surgical Instrument	H5	U.F.O. Surgical Instrument	H5
UNOVET GROUP	G12	Word Synergy Trading Co.,Ltd.	H6
VETPLUS INTERNATIONAL LIMITED	B6	ASAVA	T1
Veterina (Thailand) Co.,Ltd	A19	SCHOOL OF VETERINARY MEDICINE, UNIVERSITY OF CALIFORNIA-DAVIS	T2
Veterinary Instrumentation Ltd	E10	Murdoch University	T3
VetMedCare	G13	WSAVA 2011, Jeju, Korea	T4
Vetquip.com.au	C9	WSAVA 2013	T5
Vinci Technology Co.,Ltd.	A2	ESAVS	T6
Virbac	F4	TVMA	T7
Veterinary Practitioner NEWS (VPN)	B7/1	FAVA & ASVP	T8
VPAT	T14	VTAT	T9
VRVC	B12	Faculty of Veterinary Technology, KU.	T10
VTAT	T9	Interdisciplinary Graduate Program in Genetic Engineering	T11
WILEY-BLACKWELL	C10	Fac.Vet Sc	T12
Word Synergy Trading Co.,Ltd.	H6	Chulalongkorn University Veterinary Alumni Association	T13
WSAVA 2011, Jeju, Korea	T4		
WSAVA 2013	T5	VPAT	T14

Path of the princess visit at EH 103

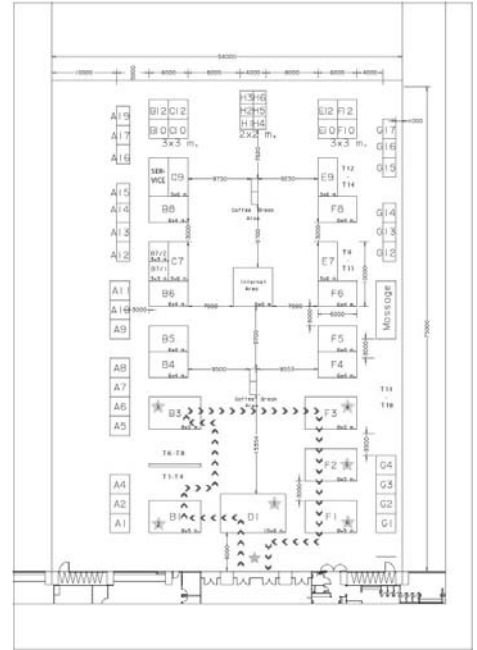

Exhibition Floor Plan and Exhibitor list

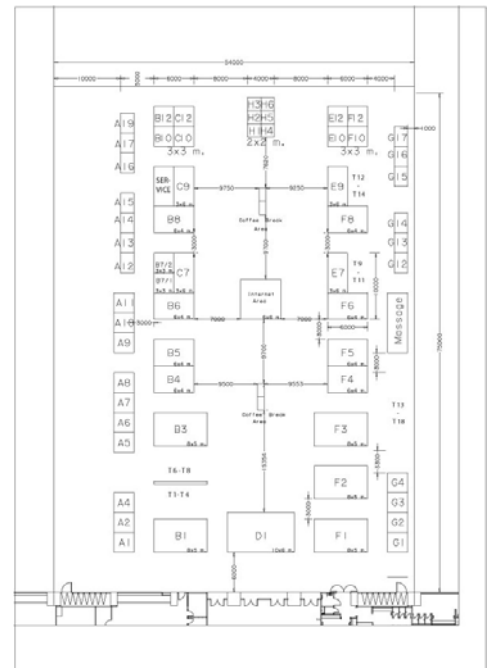

General Information

Congress Venue

Bangkok International Trade and Exhibition Centre (BITEC)
88 Bangna-Trad Road (Km.1), Bangna, Bangkok 10260, Thailand
Tel: +66(0) 2749-3939 Fax: +66(0) 2749-3959 E-mail: SalesEnquiries@bitec.net
Website: www.bitec.net

Thai useful sentence for taking taxi

Hello

sà-wàt-di

สวัสดี

Please Take me to BITEC Bangna Chuay phaa chǎn pai-thí BITEC Bangna ช่วยพาฉันไปที่ไบเทคบางนา

Secretariat Office

ProCongress (Thailand) Co. Ltd.
4/383 Moo 6 Soi Nakniwas 37 Rd. Ladprao Bangkok 10230, Thailand
Tel: +66(0) 2956-1580 Fax: +66(0) 2932-4454 E-mail: info@procongress.net

Registration and Information Desk

Registration desk will be located in front of EH103, Ground Floor, Bangkok International Trade & Exhibition Centre (BITEC). The registration opening hours are as followed:

Monday, 2 November 2009	8:00 - 19:00 hrs
Tuesday, 3 November 2009	7:00 - 08:00 and 10:30 – 17:30 hrs
Wednesday, 4 November 2009	7:30 – 17:30 hrs
Thursday, 5 November 2009	7:30 – 17:30 hrs

Registration Procedure

- Pre Registration : Please present your “registration confirmation” at the registration desk. For delegate who has “0” balance payment, please contact at “Pre Registration” counter. For delegate who has “left over” payment, please contact at cashier counter
- On-Site registration: Please fill in on-site registration form at “Form Filling” counter. Then please proceed your payment at “Cashier” for badge issue.
Note : Delegate bag is limited as first-come, first-serve basis.

Group Picking-up Badges

Please be advised that Group Registered will be receiving their badge at once by Group Manager/Authorized person on 2nd November, 09 only. The registration hours are 08.00 – 19.00 hrs.

On-Site Registration Fees

OVERSEA

Member of WSAVA and FASAVA	520 Euro
Non-Member of WSAVA and FASAVA	650 Euro
Oversea Student /Nurse	430 Euro
Member of WSAVA and FASAVA One Day	220 Euro
Non-Member One Day	270 Euro
Accompanying Person	150 Euro
International and Speaker Night	79 Euro

LOCAL

Member of TVMA and VPAT	10,000 Baht
Non-Member of TVMA and VPAT	15,000 Baht
Local Veterinary Student	3,500 Baht

Member of TVMA and VPAT One Day	2,500 Baht
Non-Member One Day	2,800 Baht
International and Speaker Night	1,600 Baht

Oversea Participants and Thai Delegate's registration fee included:

- 3 Days Congress
- Lunch Buffet/2 Coffee Breaks
- Delegate Bag (Limited)
- Final Program (Limited)
- Welcome Reception (2nd November)
- Opening Ceremony (3rd November)
- Closing Ceremony (5th November)
- Access to Exhibition

Local Veterinary Student's registration fee included:

- 3 Days Congress
- Lunch coupon valid 100 baht/day
- Delegate Bag (Limited)
- Final Program (Limited)
- Opening Ceremony (3rd November)
- Access to Exhibition

One Day's registration fee included:

- 1 Day Congress
- Lunch Buffet/2 Coffee Breaks
- Delegate bag (Limited)
- Final Program (Limited)
- Access to Exhibition

Accompanying Person's registration fee included:

- Lunch Buffet/2 Coffee Breaks
- Welcome Reception (2nd November)
- Opening Ceremony (3rd November)
- Closing Ceremony (5th November)
- Access to Exhibition
- One Day Complimentary Tour on 4th November to the Grand Palace

Registration or balance fees shall be paid by cash or credit card in THB, EURO or USD. Visa and Master card are accepted. Only THB change shall be paid for cash payment.

Badges

Official name badges are required for admission to all symposium activities. Different badge types are issued to VIP, committee, speaker, delegate, student, accompanying, one day, and exhibitor with special color coding.

Message Center

Congress participants may read, leave, or retrieve messages for or from anyone at the Message Center located at the Main Lobby 1st floor of Bangkok International Trade and Exhibition Centre (BITEC).

Certificates of attendance

The Certificates of attendance is inserted in the delegate bag.

Speaker Slide Preview

Invited speakers and oral presentation authors are requested to upload their presentation at least 8 hours before the session.

The Slide Preview Room is located at room MR210 on the 2nd floor of Bangkok International Trade and Exhibition Centre (BITEC). The facility will be open for downloading presentations on 2 November at 13:00 – 19:00 hrs, 3-4 November at 08:00 -18:00 hrs, and 5 November at 08:00 – 16:00 hrs.

The Oral Presentation Rooms are allocated as following details:

Oral Presentation for the 2nd FASAVA 2009 - room MR221 on the 2nd floor of BITEC.

Oral Presentation for the 35th VMLDAC 2009 - room MR220 on the 2nd floor of BITEC.

Poster Presentation

Poster presentations can be exhibited on Monday, 2 November 2009 between 17.30 to 20.00 hrs and on Tuesday, 3 November 2009 between 07:00 – 09:00 hrs and can remain up until 5 November 2009. The Poster Presentation area is located in Pre-function area, 2nd Floor of Bangkok International Trade and Exhibition Centre (BITEC).

The poster assistant will be available to assist the author at the Poster Presentation area during the available date and time.

Authors are requested to present at their posters during the poster session on Wednesday, 4 November 2009 from 14:30 – 15:20 hrs.

You can remove your poster on Wednesday, 4 November 2009 between 18:00 – 19:00 hrs. and on Thursday, 5 November between 18:00 – 19:00 hrs. All remaining posters shall be disposed off after 20:00 hrs on Thursday, 5 November. The conference assumes no responsibilities for the condition of posters not removed by the presenters.

Congress Language

The congress language is English. Simultaneous interpretations in Korean, Mandarin, and Thai will be provided only for Plenary Session room GH 203 on 3-5 November 2009.

Continuing Education Credits

Each day (morning and evening sessions) equal 6 CE credits. A record of participant for Continuing Education Credits form is available at the Information Desk located in front of the exhibition hall EH 103.

Proceeding Book

Proceeding Book will be available for purchase in the printed form at registration counter between 3 to 5 November 2009, or for order via email operation2@procongress.net. Each proceeding book cost THB 1,750 / USD 50 including 7% VAT. Guest speakers and registered authors will receive a complimentary proceeding book.

Exhibition Hours

Exhibition hall hours are:

Tuesday, 3 November 2009	10:30 – 18:30 hrs
Wednesday, 4 November 2009	08:00 – 18:30 hrs
Thursday, 5 November 2009	08:00 – 18:00 hrs

Business Center

The Business Center, located at the 1st floor of BITEC is open daily from 07:00 – 18:00 hrs to all delegates and guests for the following services:

- Photocopying
- Telephone calls
- Faxes
- Internet
- Printing

Prayer Room

A prayer room located at B1 floor is open daily from 08:00 – 18:00 hrs.

First Aid

For medical assistance, please proceed the First Aid Service located in front of Exhibition Hall EH 104

Smoking

Bangkok International Trade and Exhibition Centre (BITEC) is a non-smoking venue.

Restaurant Facilities

Fahrenheit Restaurant serving Thai and International food, located at the 1st floor of BITEC. The International Food Court offering a wide variety of cuisine types located at the basement of BITEC.

Emergency Calls

Mobile Police	191
Tourist Information (TAT Head Office)	+66 (0) 2250 5500
Tourist Information (Airport Office)	
- Terminal I :	+66 (0) 2523 8972-3
- Terminal II :	+66 (0) 2535 2669
Tourist Police	1155
Tourist Service Centre	1155

Official Hotels

Arnoma Hotel Bangkok

99 Rajdamri Road, Pathumwan, Bangkok, Thailand
Tel: +66 (0) 2655 5555
Fax: +66 (0) 2655 7555

Avana Bangkok Hotel

900 Moo 12 Bangna Trad Rd. Km2 Bangna Bangkok 10260 Thailand
Tel: +66 (0) 2763 2900
Fax: +66 (0) 2744 4298-9

Baiyoke Sky Hotel

222 Rajprarop Road, Rajthevee, Bangkok 10400 Thailand
Tel: +66 (0) 2656 3000
Fax: +66 (0) 22656 3555

Convenient Park Hotel

12 Sukhumvit 64, Phakhanong, Bangjak, Bangkok 10260 Thailand
Tel: +66 (0) 2741 6710-7
Fax: +66 (0) 2311 5104

Dusit Princess Srinakarin

53 Srinakarin Road, Nongbon, Pravet, Bangkok 10250 Thailand
Tel: +66 (0) 2721 8400
Fax: +66 (0) 2721 8432

Dusit Thani

Address: 946 Rama IV Road, Bangkok 10500
Tel: +66 (0) 2200 9000
Fax: +66 (0) 2236 6400

Holiday Inn Bangkok (Ploenchit)

23rd Floor, The Millennia Tower, 62 Langsuan Rd. Lumpini, Pathumwan, Bangkok 10330 Thailand
Tel: +66 (0) 2651 9501
Fax: +66 (0) 2651 9505

Imperial Queen's Park

199 Sukhumvit Soi 22, Bangkok 10110 Thailand
Tel: +66 (0) 2261 9000
Fax: +66 (0) 2261 9530-4

Intercontinental Hotel Bangkok

973 Ploen Chit Road, Patumwan, Bangkok 10330 Thailand
Tel: +66 (0) 2656 0444
Fax: +66 (0) 2656 0555

Landmark

138 Sukhumvit Road, Bangkok 10110 Thailand
Tel: +66 (0) 2254 0404
Fax: +66 (0) 2253 4259

Le Fenix Sukhumvit

33/33 Sukhumvit Soi 11 Klong Toey Nua, Wattana Bangkok 10110 Thailand
Tel: +66 (0) 2305 4000
Fax: +66 (0) 2305 4005

Novotel Bangna

333 Srinakarin Road, Nongbon, Pravet, Bangkok 10250 Thailand
Tel : +66 (0) 2366 0505
Fax : +66 (0) 2366 0506

Rembrandt

19 Sukhumvit Soi 18, Klong Toei, Bangkok 10110 Thailand
Tel: +66 (0) 2261 7100
Fax: +66 (0) 2261 7017

The Ambassador Hotel

171 Sukhumvit Soi 11, Bangkok 10110 Thailand
Tel: +66 (0) 2254 0444
Fax: +66 (0) 2253 4123

The Westin Grande Sukhumvit

259 Sukhumvit Road, Bangkok 10110 Thailand
Tel: +66 (0) 2207 8000
Fax: +66 (0) 2255 2441

Unico Grande Silom Hotel

533 Silom Road Bangkok 10500 Thailand
Tel: +66(0) 2237 8300-4
Fax: +66 (0) 237-8286

Shuttle Service**Airport Shuttle Service**

- **From Suvarnabhumi Airport to Main Official Hotels**

Greeting counter of 2nd FASAVA 2009 will be available to welcome all delegates at Suvarnabhumi Airport (please check for location map from www.fasava2009.com)

A passenger van shall leave every hour from 0:00 hrs to 24:00 hrs on 2nd November

A van shall stop at below official hotels from Bangna area to Sukhumvit Area.

Sukhumvit

- Imperial Queen's Park

Bangna

- Dusit Princess Srinakarin
- Novotel Bangna
- Avana Bangkok Hotel
- Convenient Park Hotel

- **From BITEC to Suwannabhumi Airport on 5th November (By Reservation ONLY)**

A passenger van will leave every 30 minutes from 15:00 to 20:00 hrs on 5th November.

The arrangement shall be provided upon registration only. Delegates and exhibitors shall register at Shuttle Table stand (Information Desk) at 2nd FASAVA 2009 congress.

- **From Main Official Hotels to Suvarnabhumi Airport (By Reservation ONLY)**

A passenger van will leave every hour from 16:00 hrs to 22:00 hrs on 5th November and every hour from 6:00 hrs to 14:00 hrs on 6th November.

A van stops are at below official hotels:

Sukhumvit

- Imperial Queen's Park

Bangna

- Dusit Princess Srinakarin
- Novotel Bangna
- Avana Bangkok Hotel
- Convenient Park Hotel

The arrangement shall be provided upon registration only. Delegates and exhibitors shall register at Shuttle Table stand (Information Desk) at 2nd FASAVA 2009 congress.

Venue Shuttle Service

- From / To BITEC – Main Official Hotels
2nd November 2009

Imperial Queen's Park/ Novotel/Dusit Princess/Avana/Convenient Park - BITEC	BITEC-Imperial Queen's Park /Novotel/Dusit Princess/Avana/Convenient Park
08:40 hrs * Except Avana and Convenient Park	
13:00 hrs	
15.00 hrs * Cancel	20.00 hrs

- 3rd - 5th November 2009

Imperial Queen's Park - BITEC	BITEC-Imperial Queen's Park
06.30 hrs (<i>3rd Nov only</i>)	17.00 hrs
07.00 hrs	18.00 hrs
08.00 hrs	
Novotel/Dusit Princess/Avana/Convenient Park - BITEC	BITEC- Novotel/Dusit Princess/Avana/Convenient Park
06.40 hrs (<i>3rd Nov only</i>) * Except Avana and Convenient Park	17.00 hrs * Cancel
07.10 hrs	18.00 hrs
08.10 hrs * Cancel	

- From / To On-nuch BTS – BITEC 2nd - 5th November 2009

On-nuch BTS - BITEC	BITEC- On-nuch BTS
7:00 hrs	7:30 hrs
7:20 hrs	7:50 hrs
7:40 hrs	8:10 hrs
8:00 hrs	8:30 hrs
8:20 hrs	8:50 hrs
8:40 hrs	9:10 hrs
9:00 hrs	9:30 hrs
9:20 hrs	9:50 hrs
10:00 hrs	11:20 hrs
11:30 hrs	12:30 hrs
17:00 hrs	13:30 hrs
17:30 hrs	14:30 hrs
18:00 hrs	17:30 hrs
18:30 hrs	18:00 hrs
19:00 hrs	18:30 hrs
-	19:00 hrs